

# RESTRICTING AN ACTIVITY/RESOURCE TO A PARTICULAR GROUP

1

## Creating a group

Go to your course page

Click  and “More...” to get to course administration page

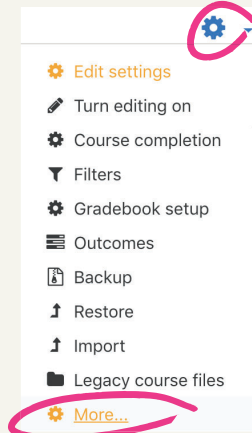

2

Select “Users” tab and select “Groups”

## Course administration

Course administration **Users** Reports

Users

Enrolled users  
Enrolment methods  
**Groups**  
Other users

Permissions

Check permissions

3

In the Groups page, select “Create group”

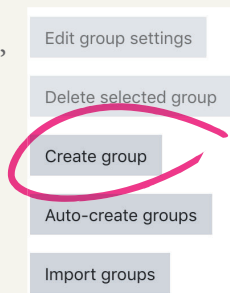

4

Input the information of your group, e.g. group name, group description and click “Save changes”

## General

Group name

Group ID number

Group description

5

- A. Select the newly created group
- B. Click “Add/remove users”

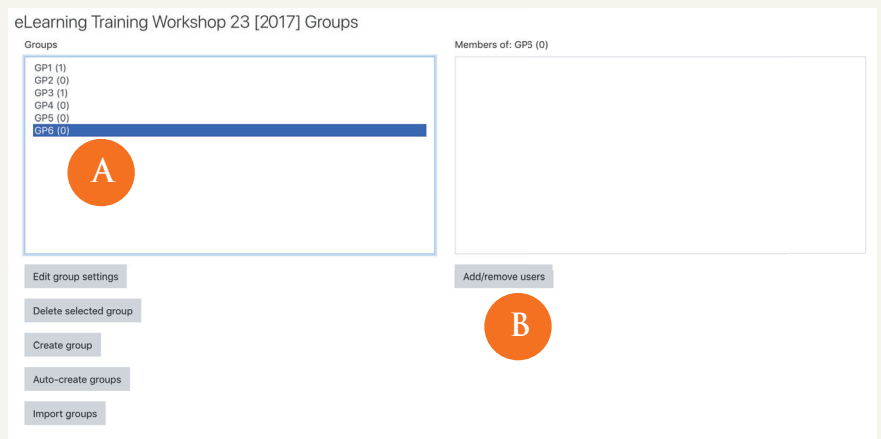

# RESTRICTING AN ACTIVITY/RESOURCE TO A PARTICULAR GROUP

6

From the “Potential members” panel, select students that you would like to add to the group

Click “Add”

Please note that teachers and teaching assistants are not required to be added to a group

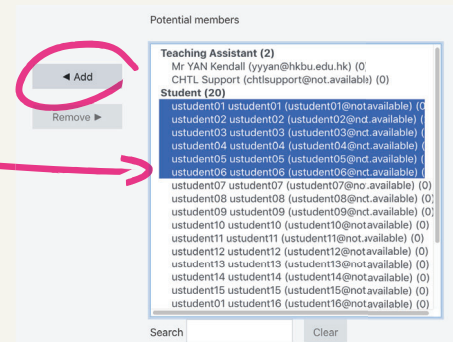

7

## Restricting access of an activity or resources

To be able to restrict an activity, resource or course topic to a group, Restrict access must be enabled. This will result in a 'Restrict access' section in the activity, resource or topic settings and a group restriction can then be added.

Go to your course page and select “Edit settings” from an activity or resources

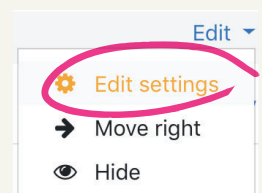

8

In the Editing page of an activity/resources, select “Add restriction” under Restrict access

## Restrict access

Access restrictions

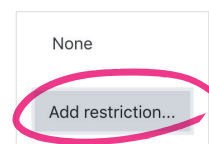

9

Select “Group” in Add restriction...

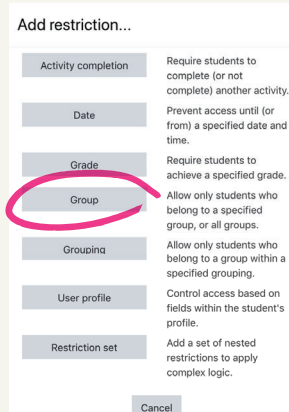

10

You can edit the settings of the restriction

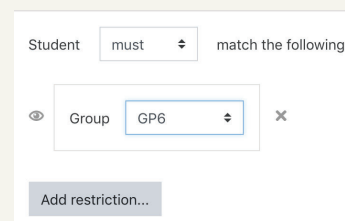

Only students in particular group match with the restriction can access the activity and resource